



CONVEYOR COMPONENTS COMPANY

130 Seltzer Road, PO Box 167 • Croswell, MI 48422 USA

PHONE: (810) 679-4211 • TOLL FREE (800) 233-3233 • FAX: (810) 679-4510

Email: info@conveyorcomponents.com • <http://www.conveyorcomponents.com>

MODEL AD-K BIN AERATOR MOUNTING KIT

The Model AD-K aerator mounting kit completely eliminates the need to enter the bin to install or service aerators. By cutting a 2-5/8" x 6-3/8" hole in the bin wall, the new mounting kit can be completely installed and serviced from outside of the bin.

After the initial hole has been cut, the aerator can be mounted on the adapter assembly and inserted into the bin in less than two minutes. There are no other holes to drill, tapping or welding. The aerator is positively sealed and securely held in place in the bin. Removal is just as simple and quick.

These aerators are also adaptable for use on round bins. Installation is made with standard gaskets, and the 3/16" adhesive gasket (figure 1, part "C"), on bins with a diameter of three feet or greater. For smaller diameter bins, a special gasket can be furnished.

Installation Instructions:

1. Cut a 2-5/8" x 6-3/8" hole in the bin wall (See tables for number of aerators and spacing).
2. Peel off the protective tape on one side of thin gasket (figure 1, part A) and attach to the front side of the adapter (part B). Refer to Figure 1.
3. Peel off the protective tape on other side of gasket (figure 1, part A) and place aerator on gasket. Uprturned edges on adapter will prevent aerator from turning in the bin.
4. Peel off the protective tape on the thick gasket (figure 1, part C) and attach to back side of adapter. Longer legs on this side of adapter keep adapter from turning when placed in bin wall hole.
5. Insert tank nipple into aerator and tighten. The end with fewer threads goes into the aerator. If the tank nipple is not secure in aerator, it may unthread when aerator is removed from bin.
6. Slip clamp (figure 1, part D) over tank nipple with legs toward aerator and thread on brass locking nut.
7. Holding the aerator by the tank nipple, slip the entire assembly through bin wall. Rotate the clamp to bridge the opening and tighten locknut. Aerator is securely held in place and hole in bin wall is positively sealed (refer to figure 3).

Figure 1: Kit Parts

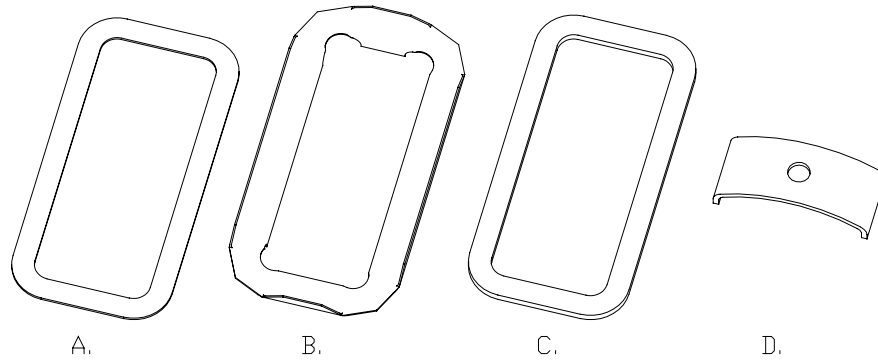

- A. 1/16" gasket with adhesive both sides
- B. Adapter (front view)
- C. 3/16" gasket, adhesive one side
- D. Spring steel clamp

Figure 2: AD-K Assembly with AD Aerator

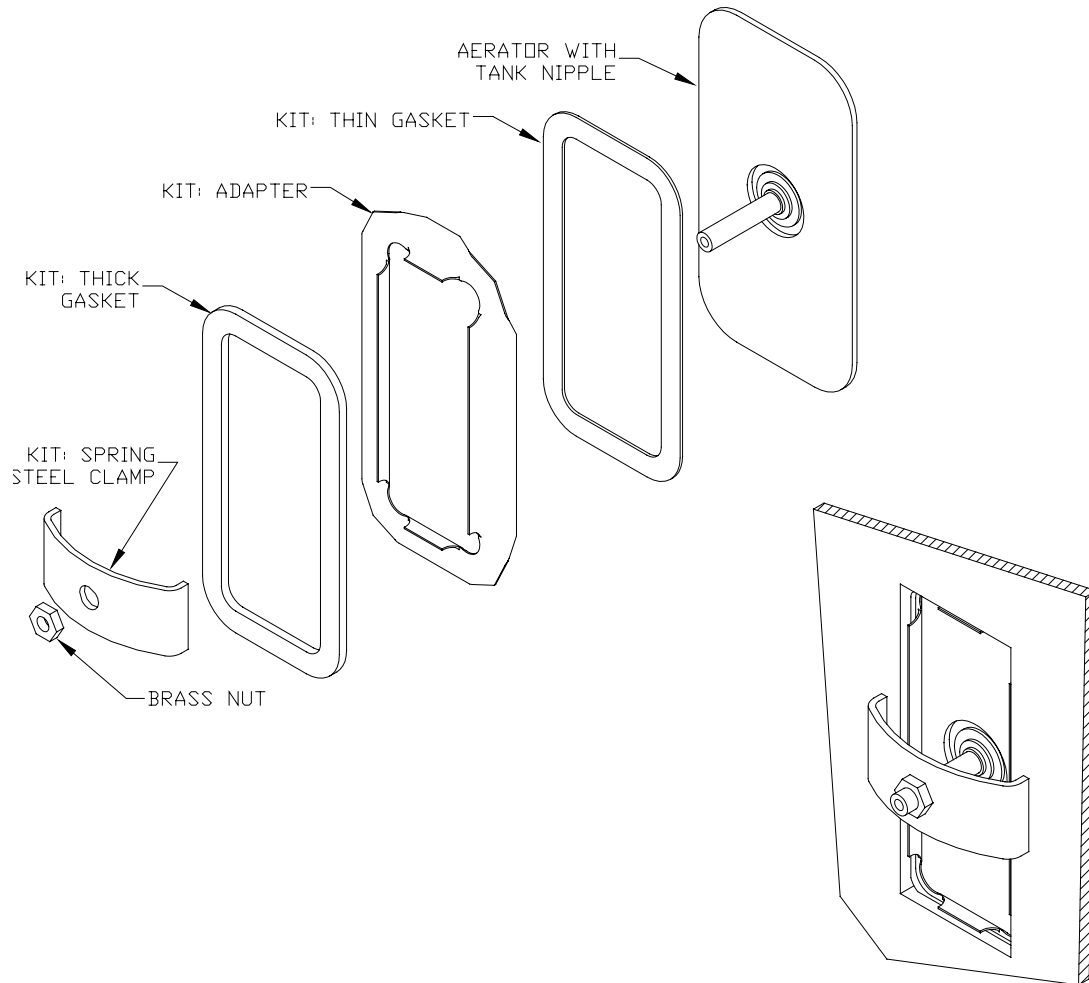

Figure 3: Aerator Kit Installed in Bin Wall